



Stourhead Drive

East Hunsbury, Northampton

oriordanbond
SALES & LETTINGS



Stourhead Drive

East Hunsbury
NN4 0UH

Price
£415,000

Offered to the market with no onward chain is this four bedroom detached family home, nestled in a desirable cul-de-sac, within East Hunsbury. The property offers good size accommodation over two floors.

Entrance hall with stairs to the first floor, cloakroom/WC and doors to all other rooms. There is a generous sitting room with bay window and double doors opening to a separate dining room, a door to a kitchen/breakfast room with integrated appliances and a separate utility room. To the first floor is a light and airy landing with access to loft space, an airing cupboard, four bedrooms with ensuite to the master bedroom and a separate family bathroom. Outside, to the front is a lawned garden and driveway leading to a tandem length integral garage. To the rear is a south/easterly facing landscaped garden with lawn, planted borders and timber fencing to enclose. Further benefits include uPVC double glazing and gas radiator heating. (B/1381/M)

- Four bedroom detached home
- En-suite to master bedroom
- Two reception rooms
- South/easterly facing rear garden
- Driveway and tandem length garage
- No onward chain





GROUND FLOOR
811 sq.ft. (75.3 sq.m.) approx.

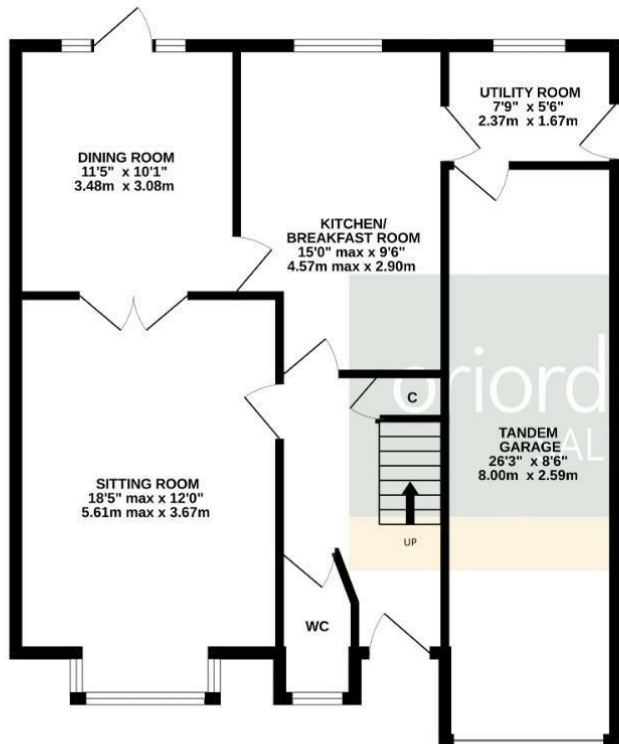

1ST FLOOR
570 sq.ft. (53.0 sq.m.) approx.

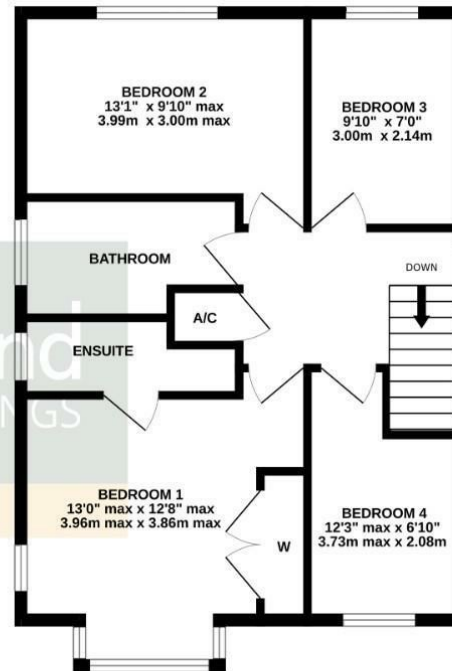

TOTAL FLOOR AREA : 1381 sq.ft. (128.3 sq.m.) approx.

Whilst every attempt has been made to ensure the accuracy of the floorplan contained here, measurements of doors, windows, rooms and any other items are approximate and no responsibility is taken for any error, omission or mis-statement. This plan is for illustrative purposes only and should be used as such by any prospective purchaser. The services, systems and appliances shown have not been tested and no guarantee as to their operability or efficiency can be given.
Made with Metropix ©2025

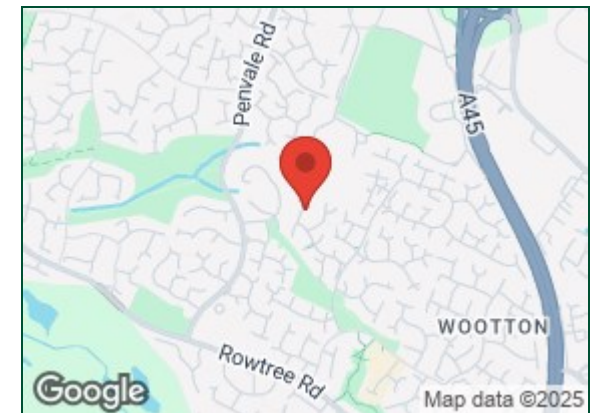

Additional information

- Council Tax Band: E
- Energy Efficiency Rating: C

Viewing

Viewing strictly by appointment – details below

Disclaimer

O'Riordan Bond Estate Agents Limited has not tested apparatus, equipment, fittings or services and so cannot verify they are in working order. The buyer is advised to obtain verification from their solicitor or surveyor.

O'Riordan Bond Hunsbury Sales

01604 706007

hunsbury@oriordanbond.co.uk

